

KEY

- 1** THOMAS BROWN & SON ROOFING
CARLISLE SURE-FLEX 60 MIL PVC
10/12 - 10/21, 15YR WARRANTY
P.O. # 37459
- 2** BRANDLE ROOFING
20 YEAR WARRANTY
- 3** CARLISLE SIVTEC INC. 80 MIL PVC
10/05 - 10/25 WARRANTY
P.O. #
- 4** RENOVATION II 2003
MID MICHIGAN ROOFING
GAR/EVERGLARD ROOF 60 MIL PVC
- 5** RENOVATION II 2003
MID MICHIGAN ROOFING
GAR/EVERGLARD ROOF 60 MIL PVC
- 6** STRENG CONSTRUCTION
GAR/EVERGLARD ROOF 60 MIL PVC
8/24/07-8/24/22 WARRANTY
P.O. # 27650
- 7** RENOVATION II 2003
VALLEY ROOFING CO.
GAR/EVERGLARD ROOF 60 MIL PVC
10 YEAR WARRANTY
- 8** MACARTHUR ROOFING
PROCESS TRAINING CENTER 2001
40 MIL DURO-LAST ROOF
15 YEAR WARRANTY
- 9** MID MICHIGAN ROOFING
JOHNS MANSVILLE ROOF 60 MIL PVC
6/11/09-6/11/24 WARRANTY
P.O. # 51123
- 10** NOT USED
- 11** NOT USED
- 12** MID MICHIGAN ROOFING
THOMAS BROWN BRANDLE BRITUMINOUS-THERMOPLASTIC
P.O. # 54013
- 13** NOT USED
- 14** C&I BUILDING SERVICES
TREMCO ALPHAGUARD BIG BASE/TOP COAT MODIFIED BIT
20 YEAR WARRANTY
P.O. # 53162
- 15** NOT USED
- 16** NOT USED
- 17** MID MICHIGAN ROOFING
TREMCO COLD-APPLIED BRITUMINOUS-THERMOPLASTIC
P.O. # 54013

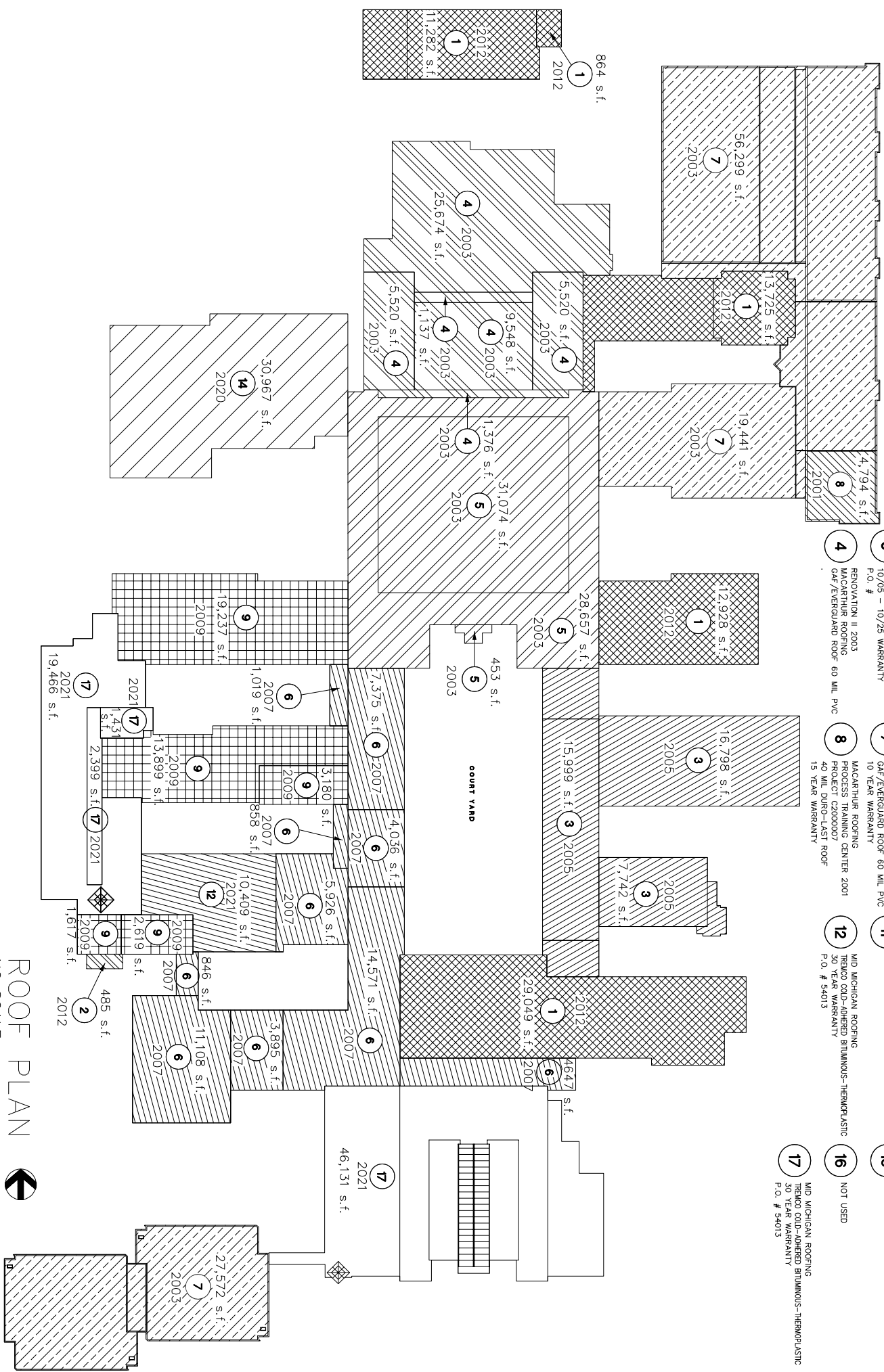

ROOF PLAN
NO SCALE

